

**Construction:**

The fixture includes a threaded base (1) to which a tray (9) with an igniter module (2) and a lampholder (3) is attached. A bulb (4) is fitted into the lampholder. A RASTER (ODB-3) reflector (5) can be used optionally. A threaded shade (6) is slid over the fixture and screwed into the female threaded base. The connection is made tight by using a gasket (7).

**Mounting instructions:**

- \*) -Attach the igniter module (2) and the lampholder (3) to the base.
- Lead the electrical cables out of the arm and place them neatly inside the fixture,
- Connect them to the igniter (2)..
- Attach the arm to the base (1).
- Put the bulb (5) in position.
- Attach a RASTER (ODB-3) reflector(5)
- Position the gasket (7) in place and screw the shade (6) all the way in.

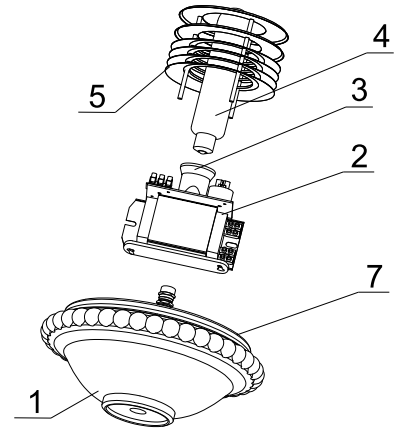
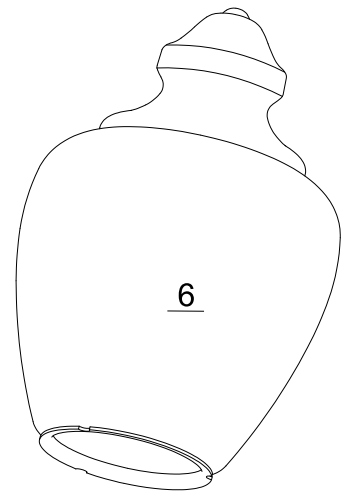

If any lantern elements are supplied factory-mounted, the mounting stages marked with \*) should be omitted (as this has already been done by the manufacturer)

**TECHNICAL DATA:**

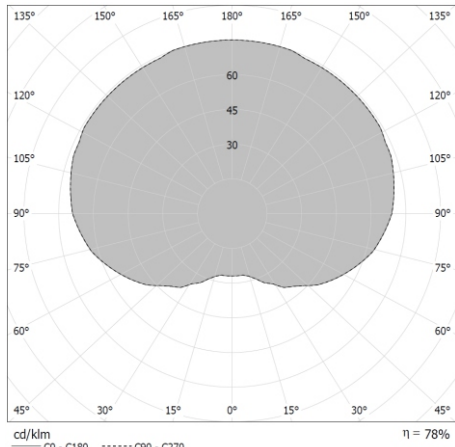

cd/klm  
C0 - C180 ..... C90 - C270  
Photometry (polar plot)

**Power: ~230/50Hz**

**Protective class: I**

**IP65 -electrical part**

**IP65 -optical part**



**ELECTRICAL DIAGRAM:**

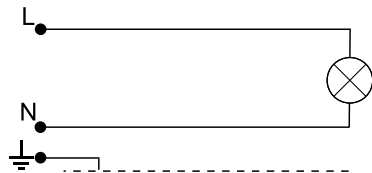

1. Incandescent bulb

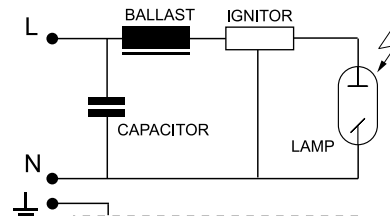

2. Sodium / metal halide lamps

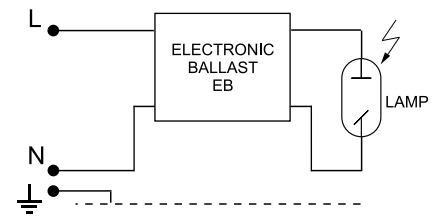

3. Sodium / metal halide lamps

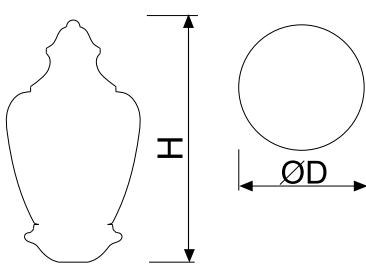
Type	Light-producing element	Lamp holder	Weight [kg]	Pn [W]		Luminary dimensions
				IC	EB	
A2MH-70W	MH/HSI/HPI	E27	7,8	81	78	 Wind area A = 0,19m <sup>2</sup> H/D 710/390
A2MH-100W	MH/HSI/HPI	E27	8,3	114	109	
A2MH-150W	MH/HSI/HPI	E27	9,0	169	164	
A2S-70W	WLS/SHP/SON	E27	7,8	81	78	
A2S-100W	WLS/SHP/SON	E40	8,4	114	109	
A2S-150W	WLS/SHP/SON	E40	9,1	169	164	
A2Z-E/Z	Bulb / MINI - LINX	E27	6,3	Max. 60		



**WARNING !!** The weight of the unit may slightly differ for individual production batches.