



art metal

23 ANTARES LED

F.P.H. Art Metal Sp.j.

Ul. Jabłoniowa 124, 83-331 Łapino Kartuskie, Poland
Tel. 0048 58 681 80 78, Fax: 0048 58 681 80 64
www.art-metal.pl e-mail: biuro@art-metal.pl

Construction:

The unit consist of a body (1). A shade (3) is mounted to the luminary body with a ring (3). A disk (4) separating electrical compartment from lighting compartment is attached to a luminary body. A LED light source radiator is settled to the disk (4). LED module is mounted to the radiator (6) and tightly closed with a lens The module is powered with a voltage power supply (7). The luminary is sealed with a gasket (8).

Mounting instructions:

- Screw the radiator (6) to mount an LED light source to the disk (4).
- Connect the electrical cables according to the scheme.
- Tighten bolts to mount a disk (4) to the luminary body (1).
- Mount the shade (2) to the body (1) with a ring (3). Tighten mounting bolts.
- The luminary is mounted to the lantern with a M20 thread (hanged luminary).

If any lantern elements are supplied factory-mounted, the mounting stages marked with *) should be omitted (as this has already been done by the manufacturer).

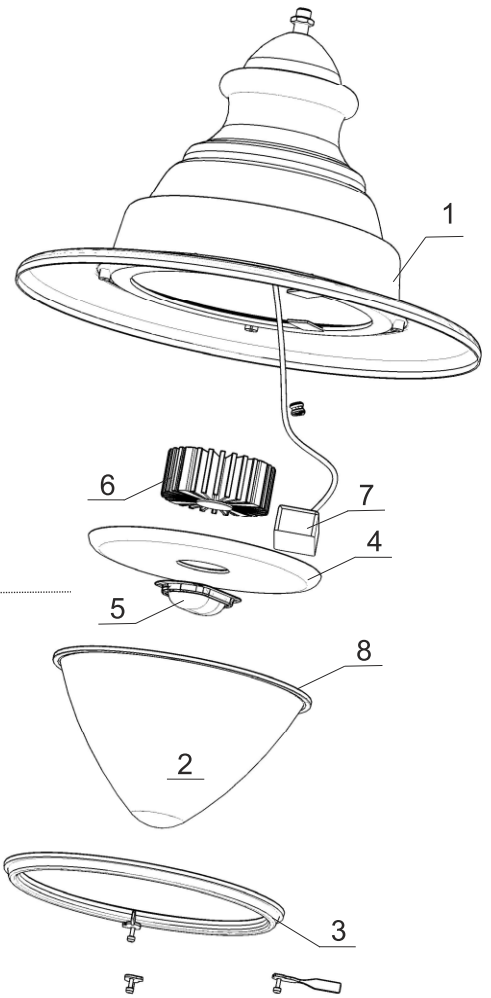

TECHNICAL DATA:

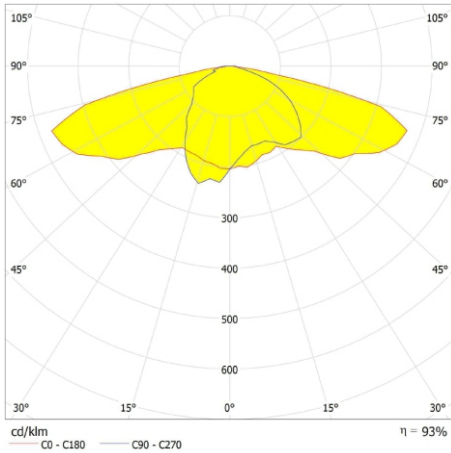

Photometry (polar plot)

Power: ~230/50Hz

Protective class: I

IP44 -electrical part

Ip65 -optical part



ELECTRICAL DIAGRAM:

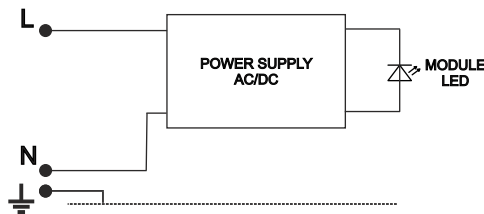

1.Module LED

| Type | Light-prod. element | Luminous flux[lm] | | Weight [kg] | Pn [W] | Luminary dimensions | |
|----------|---------------------|-------------------|-------|-------------|--------|-------------------------------------|----------------|
| | | 3000K | 4000K | | | | |
| 23 L-33W | NZL33(Cree) | 3777 | 4062 | 16,5 | 33 | Wind area A = 0,18m ² | L/D 640/700 |
| 23 L-38W | NZL38(Cree) | 4227 | 4546 | 16,5 | 38 | | |
| 23 L-50W | NZL50(Cree) | 5228 | 5622 | 16,5 | 50 | | |
| 23 L-58W | NZL58(Cree) | 5784 | 6220 | 16,5 | 58 | | |
| 23 L-78W | NZL78(Cree) | 6948 | 7471 | 16,5 | 78 | | |
| | | | | | | | |



WARNING !! The weight of the unit may slightly differ for individual production batches.

